



CATALOG NUMBER	TYPE
PROJECT NAME	DATE

## SPECIFICATIONS

### FEATURES

- Thermoplastic emergency light with polycarbonate shield
- Designed for locations where rugged protection is required
- Designed for wall mounting
- Fast, easy installation
- Part of Astralite's quick ship program

### CONSTRUCTION

- Injection molded thick polycarbonate encloses the TP-100 fixture
- Mounts using a .1" thick stainless steel back plate
- VRS option includes Tamperproof Mounting Screws
- 4x option includes Neoprene gaskets suitable for hose down applications

### LAMP

- Utilizes two 1W LED heads in emergency mode; higher wattage lamps are available upon request, consult factory for more options

### ELECTRONICS

- Dual-voltage input capability: 120/277V
- Low-voltage disconnect
- AC lockout installation
- AC indicator light with test switch
- Brownout protection

### BATTERY

- Lead-calcium battery is standard and provides a minimum of 90 minutes of illumination in emergency mode; Nickel-cadmium battery offered as an option
- Operating temperature range: 10-40° C

### COMPLIANCE

- Meets or exceeds UL 924, NFPA 101, NEC and OSHA illumination standards

### WARRANTY

- 5-year warranty on housing and electronics. Battery is prorated

## TP-100-LED-VRS/4X

### VANDAL RESISTANT EMERGENCY UNIT



## DIMENSIONS

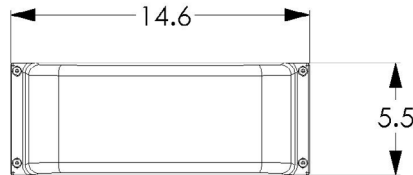
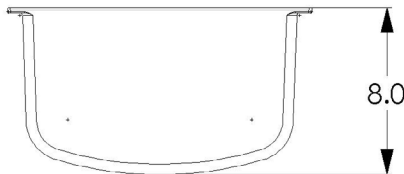

Material	Mounting	Battery	Code Compliance	Dimensions
Polycarbonate	Wall	Nickel-cadmium	UL 924	14.6" W X 8" D X 5.5" H

## ORDERING GUIDE

MODEL	TYPE	INTEGRAL LAMPS	HOUSING	OPTIONS
TP-100-LED Thermoplastic Emergency Unit	VRS 4X Vandal Resistant Water Resistant	2X1 2x1W LED	W B White Black	220 SD TMP <sup>1</sup> TPSD 220 VAC Input Self Diagnostics Taperproof Screws Tamperproof Screwdriver

### Notes:

1. Standard for VRS