



CATALOG NUMBER	TYPE
PROJECT NAME	DATE

SPECIFICATIONS

FEATURES

- Aluminum edgelit EXIT-EM combination unit
- Designed for recessed ceiling mount applications
- Optional remote capability: 10W at 6V
- Features two telescoping lamp heads

CONSTRUCTION

- Aluminum trim plate; choice of five finishes: brushed aluminum, white, black, dark bronze, and brass; contact factory for custom finishes
- EXIT letters are 6" tall with 3/4" stroke; 100 ft viewing distance
- Field-selectable chevron directional indicator offers a choice of direction on-site

LAMP

- Utilizes two 10W halogen or 1W LED MR-16 lamps with telescoping head design in emergency mode; contact factory for additional lamp options

ELECTRONICS

- Dual-voltage input capability: 120/277V
- Low-voltage disconnect
- AC lockout installation
- Brownout protection
- AC indicator LED light

BATTERY

- Lead-acid battery is standard; nickel cadmium battery offered as an option
- Provides a minimum of 90 minutes of illumination in emergency mode
- Operating temperature range: 0 °C to 40 °C

COMPLIANCE

- Meets or exceeds UL 924, NFPA 101, NEC and OSHA illumination standards

WARRANTY

- 5-year warranty on housing and electronics. Battery is prorated

ELX-MR

EDGE LIT EXIT-EM COMBINATION UNIT



DIMENSIONS

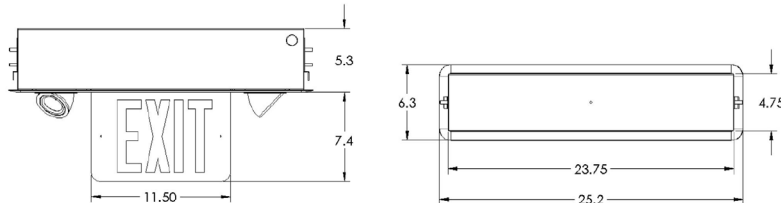

Material	Mounting	Battery	Code Compliance
Aluminum	Ceiling	Lead-acid	UL 924

ORDERING GUIDE

MODEL	NO. OF FACES	LETTER/BACKGROUND	TRIM FINISH	OPTIONS
ELX-MR	1	Single	BA Brushed Aluminum WH White BK Black DB Dark Bronze BR Brass Finish	220 220 VAC Input SD Self Diagnostics REM Remote 6v 10W Output NC Nickel-Cadmium Battery LED 2x1W LED Lamps
	2	Double		

Notes:

1. Single face only